

TABLE 2 TERMINAL SPECIFICATION			
LEAD STYLE	TERMINAL	OVERALL LENGTH	
-07 (1)	T-1S6-07-X-2	.430	[10.92]
-08 (1)(2)	T-1S6-08-X-2	.530	[13.46]
-09	T-1S6-09-X-2	.730	[18.54]
-10	T-1S6-10-X-2	.830	[21.08]
-11	T-1S6-11-X-2	.930	[23.62]
-12	T-1S6-12-X-2	1.030	[26.16]
-13	T-1S6-13-X-2	1.230	[31.24]
-14	T-1S6-14-X-2	1.430	[36.32]
-15 (1)(2)	T-1S6-15-X-2	.630	[16.00]
-16 (1)	T-1S6-16-X-2	.445	[11.30]
-17 (1)	T-1S6-17-X-2	.480	[12.19]
-19	T-1S6-19-X-2	1.330	[33.78]
-20	T-1S6-20-X-2	1.130	[28.70]

(1) -LL AVAILABLE IN .230 [5.84] POST  
 (2) -LL AVAILABLE IN .300 [7.62] POST

LCW-1XX-XX-X-X-XXX-XX

NO. OF POSITIONS (-01 THRU -36)  
 "A" = NO OF POS. x .100 [2.54]

LEAD STYLE (SEE TABLE 2)

PLATING SPECIFICATIONS  
 -G: GOLD-SPECIFY "G" IN TERMINAL SPEC. AT "X" IN TABLE 2  
 -T: TIN-SPECIFY "T" IN TERMINAL SPEC. AT "X" IN TABLE 2  
 -S: SELECTIVE-SPECIFY "S" IN TERMINAL SPEC. AT "X" IN TABLE 2  
 -L: LIGHT GOLD-SPECIFY "L" IN TERMINAL SPEC. AT "X" IN TABLE 2  
 -H: HEAVY GOLD-SPECIFY "H" IN TERMINAL SPEC. AT "X" IN TABLE 2 (AVAILABLE ON -07, -08, & -09 STRAIGHT LEAD STYLES ONLY)  
 -F: FLASH SELECTIVE GOLD- SPECIFY "F" IN TERMINAL SPEC. AT "X" IN TABLE 2  
 -P: GOLD FLASHED PALLADIUM NICKEL- SPECIFY "P" IN TERMINAL SPEC. AT "X" IN TABLE 2

LEAD FORM SPECIFICATION  
 BLANK: SEE ASM. 1  
 RA: SEE ASM. 2  
 RE: SEE ASM. 2  
 RP: SEE ASM. 2 & IN-PROCESS  
 PR: SEE ASM. 3 & IN-PROCESS  
 RR: SEE ASM. 3  
 LL: SEE ASM. 5  
 (N/A IN SINGLE ROW, 1 & 2 POSITIONS OR ANY RX, OR XR LEAD STYLES)  
 XX: SEE ASM. 6

POST LENGTH "B"  
 (SPECIFIED BY CUSTOMER)  
 -230 = .230 [5.84]  
 -300 = .300 [7.62]  
 (-300: N/A IN STYLES -7,-16,-17)

BODY SPECIFICATION  
 -S: SINGLE (USE LCW-36-S)  
 -M: SINGLE MODIFIED (USE LCW-36-S) SEE ASM. 4.

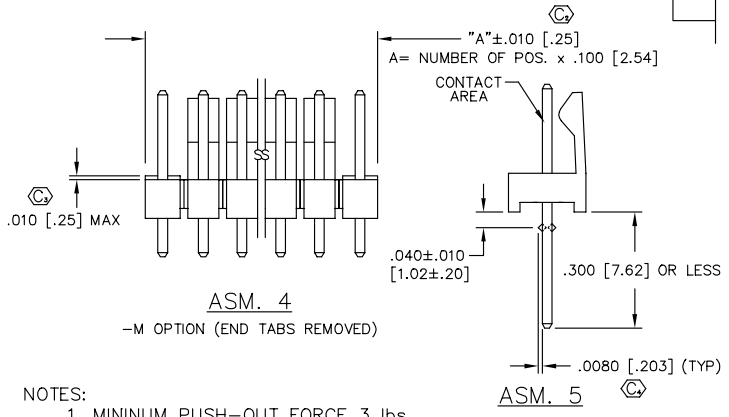
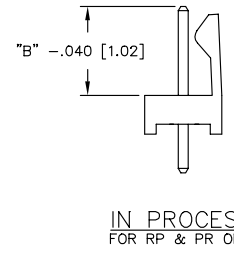
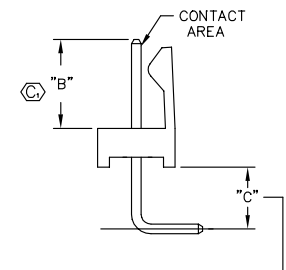
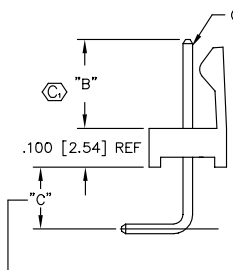
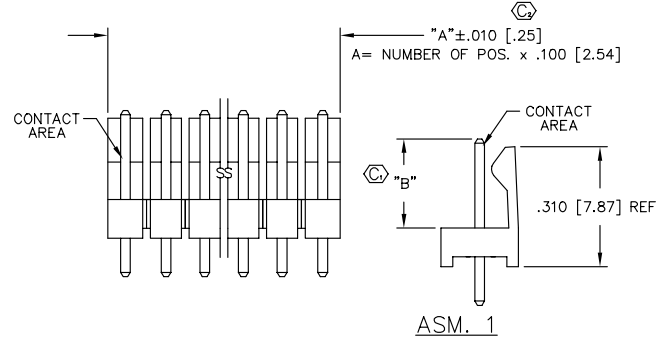

RA: C=.060±.010 [1.52±.25]  
 RE: C=.160±.010 [4.06±.25]  
 RP: C=.020 [.51] MINIMUM

PR: C=.020 [.51] MINIMUM  
 RR: C=.060±.010 [1.52±.010]

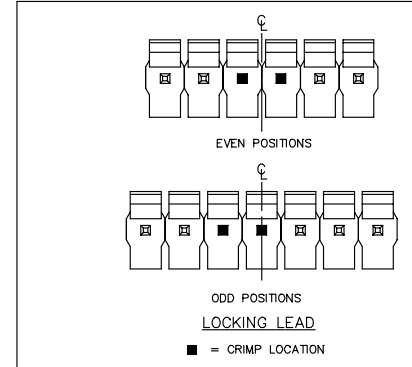
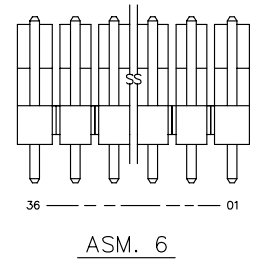

NOTES:  
 1. MINIMUM PUSH-OUT FORCE 3 lbs.  
 2. HEIGHT VARIATION BETWEEN ANY TWO PINS SHALL BE .010 [.25] MAX.  
 3. (⊗) REPRESENTS CRITICAL DIMENSION FOR STATISTICAL PROCESS CONTROL.

**PROPRIETARY NOTE**  
 THIS DOCUMENT CONTAINS INFORMATION CONFIDENTIAL AND PROPRIETARY TO SAMTEC INC. THIS SHALL NOT BE REPRODUCED OR TRANSMITTED IN ANY FORM OR BY ANY MEANS, ELECTRONIC OR MECHANICAL, INCLUDING PHOTOCOPYING, RECORDING, OR BY ANY INFORMATION STORAGE AND RETRIEVAL SYSTEM, WITHOUT THE EXPRESS WRITTEN CONSENT OF SAMTEC INC.

MATERIAL  
 -VALOX DR-48 OR  
 -APPROVED SAMTEC ENG. EQUIVALENT.  
 COLOR: -BLACK

TERMINALS:  
 PHOSPHOR BRONZE, ALLOY NO. 510, 3/4 HARD, TENSILE RANGE 95-105 KSI

MISC MKTG  
LCW-MKT

**samtec**

520 PARK EAST BLVD. NEW ALBANY, INDIANA 47150  
 PHONE (812) 944-6733 P.O. BOX 1147  
 CODE 55322

MADE BY: T.Y. 1-11-85  
 CHECKED BY: L.WILLIAMS

ENG. APPROVAL  
TMH

LCW-1XX-XX-X-X-XXX-XX  
 SHEET 1 OF 1